

CCV-EXT-KIT, CCV and PICCV Valve Neck Extension Kit

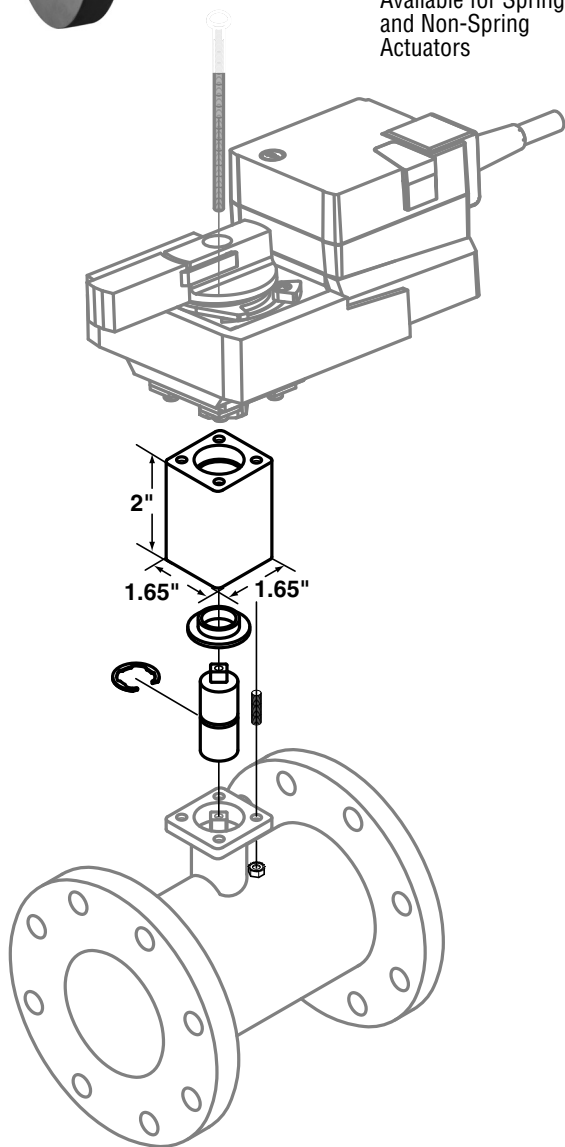

Available for Spring
and Non-Spring
Actuators



Application

The CCV-EXT-KIT can be used with most CCV's* and PICCV in order to achieve a large clearance over the pipe. The Extension Kit will provide an additional 2" of space between the top of the valve and the base of the actuator. bracket is made from aluminum and is not intended as a thermal block.

- Extension kit will be automatically assembled with any Flanged CCV assembly.

Technical Data

Extension Height	2"
Total Weight	0.7 lb

Material

Extension Housing	Aluminum - Anodized
Shaft	Stainless Steel
Threaded Hardware	Stainless Steel
Bearing	Oilite® Bearing
Retaining Clip	Stainless Steel

	TR	LRB (X)	ARB (X)	TF	LF	AF
Extension Bracket CCV-EXT-Kit	●	●	●	●	●	●

- * Cannot be used with N4 actuators.
- * Available for previous NF assemblies.
- * CCV-EXT-KIT cannot be used with any valve smaller than the B212(B) and B312(B).
- * For use with B2 and B3 series only. Cannot be used with B6 series.