

Shaft clamp reversible

- for LF..
- clamping range $\varnothing 16 \dots 20$ mm

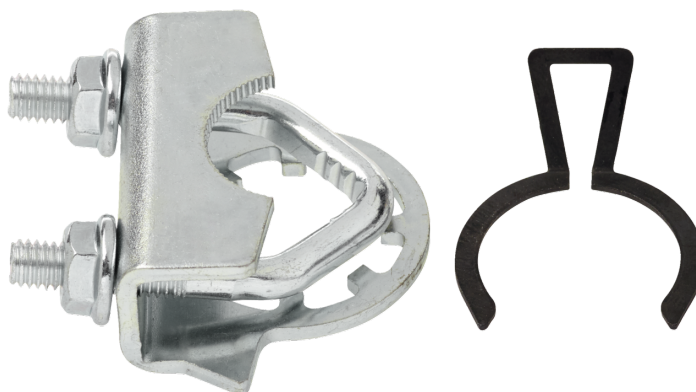

Picture may differ from product

Technical data

Weight	Weight	0.062 kg
Materials	Used materials	Galvanised steel

Safety notes



- This accessory has been designed for use in stationary heating, ventilation and air-conditioning systems and must not be used outside the specified field of application, especially in aircraft or in any other airborne means of transport.
- Only authorised specialists may carry out installation. All applicable legal or institutional installation regulations must be complied with during installation.
- The accessory may not be disposed of as household refuse. All locally valid regulations and requirements must be observed.

Product features

Application Suitable for LF..

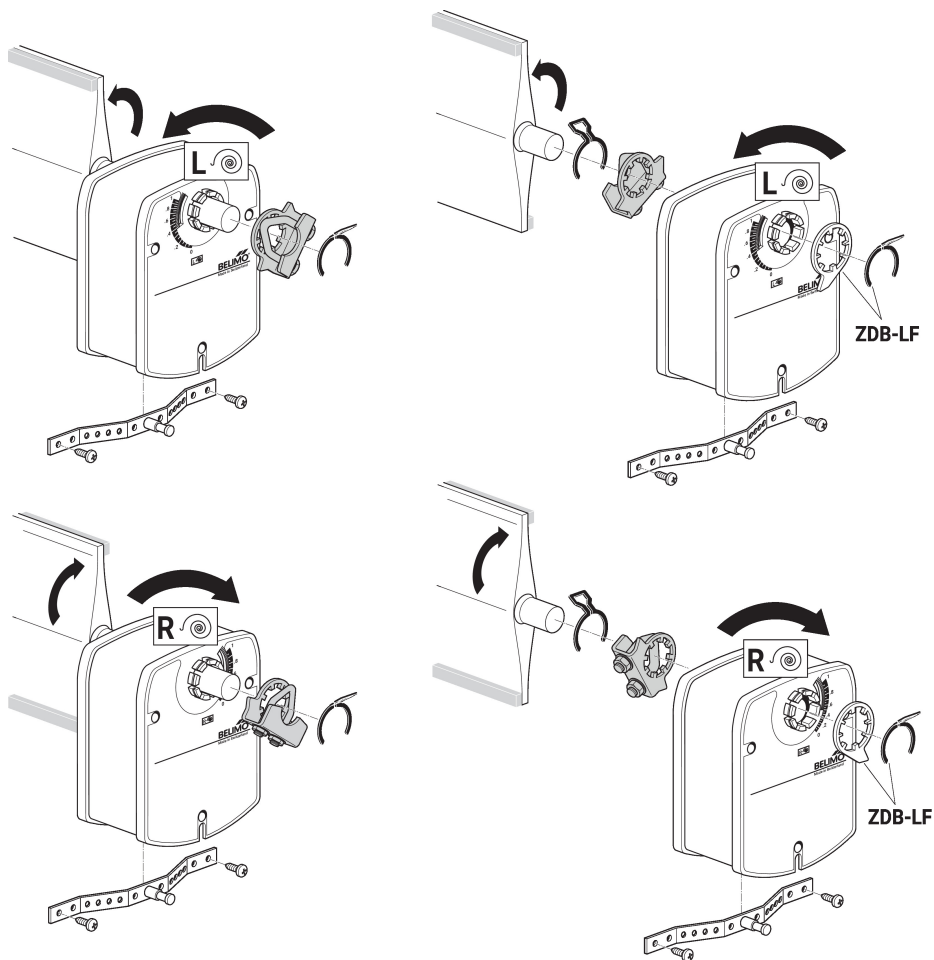
Dimensions

Type
K6-1

Weight
0.062 kg