

## Baseplate extension

- for GM..A to GM..

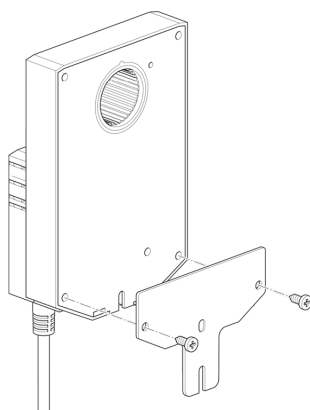

Picture may differ from product

## Technical data

<b>Weight</b>	Weight	0.083 kg
<b>Materials</b>	Used materials	Galvanised steel

## Safety notes



- This accessory has been designed for use in stationary heating, ventilation and air-conditioning systems and must not be used outside the specified field of application, especially in aircraft or in any other airborne means of transport.
- Only authorised specialists may carry out installation. All applicable legal or institutional installation regulations must be complied with during installation.
- The accessory may not be disposed of as household refuse. All locally valid regulations and requirements must be observed.

## Product features

**Application** Suitable for GK..A, GM..A

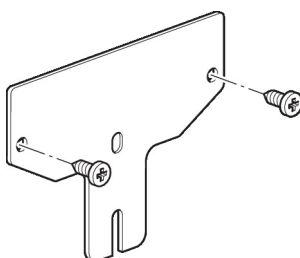

## Dimensions

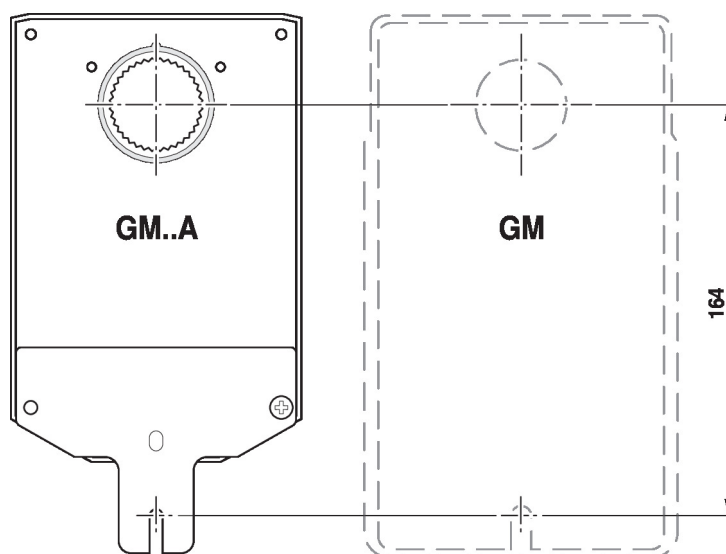

## Type

Z-GMA

## Weight

0.083 kg