

5

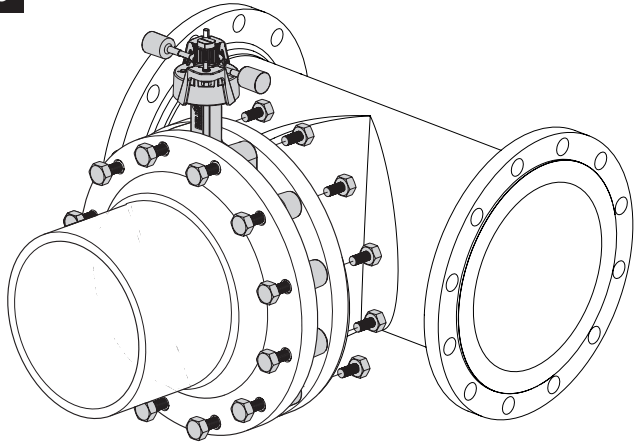

6

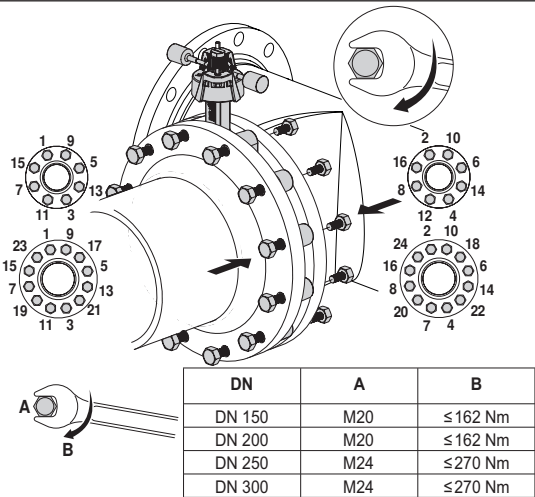

6i

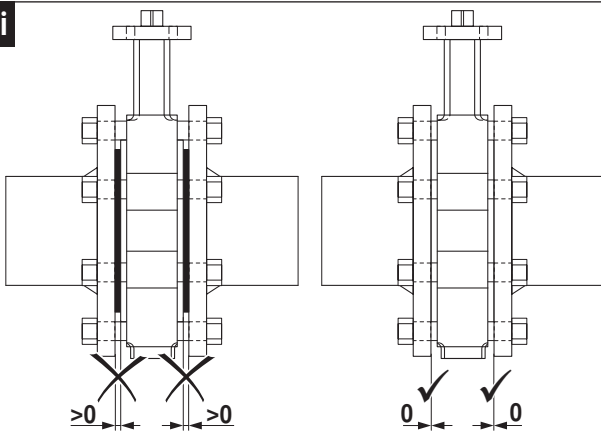

i

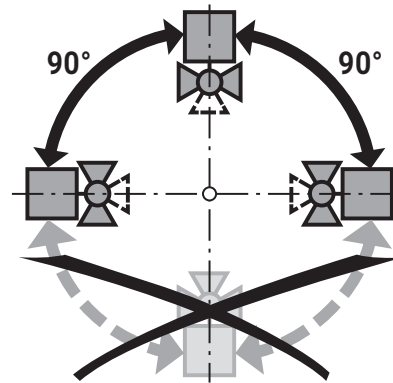

i

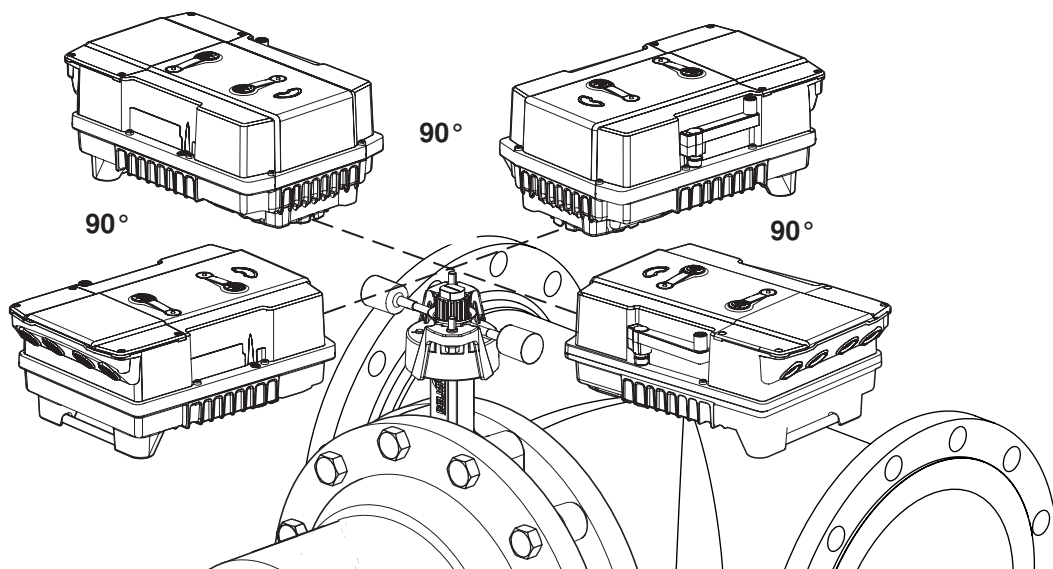

7

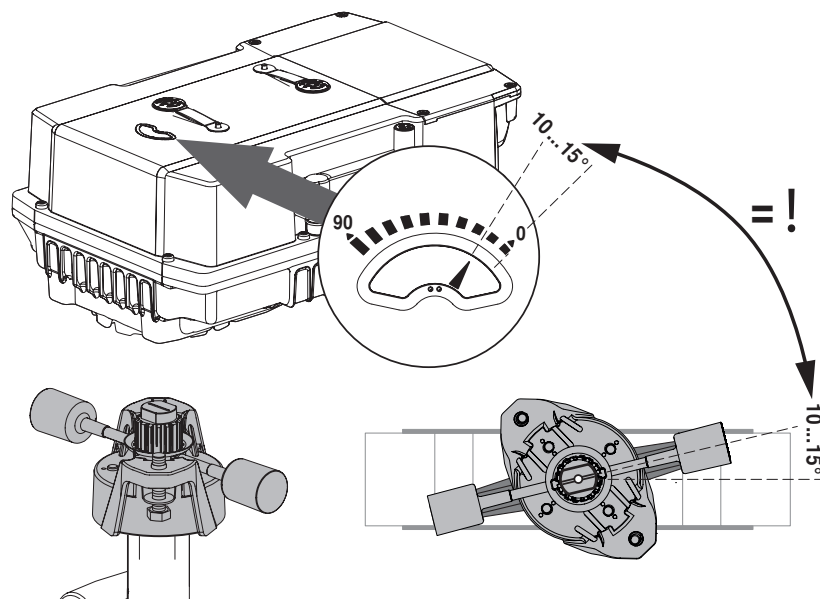

8

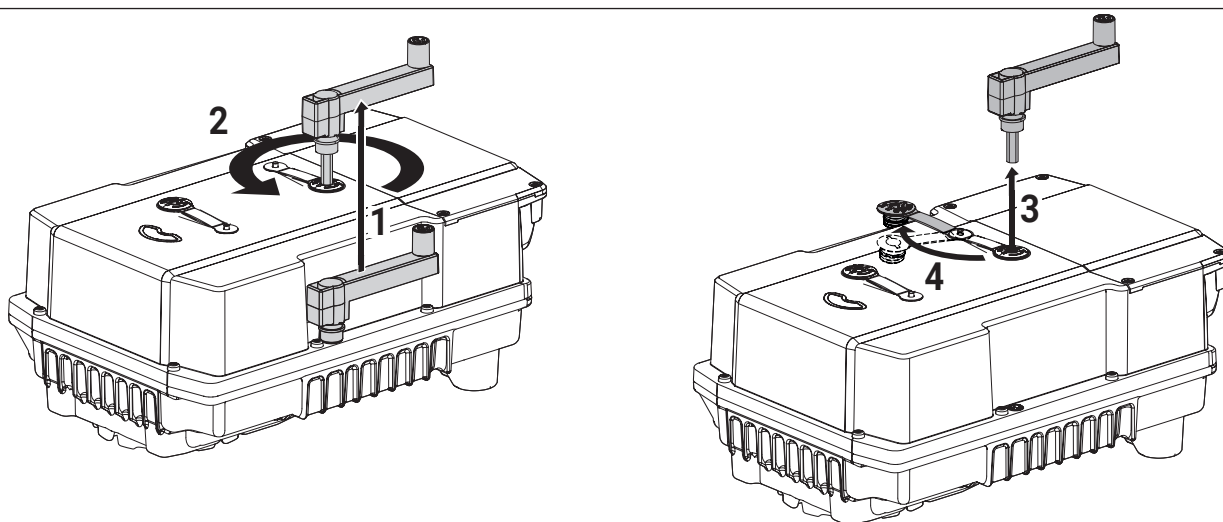

9

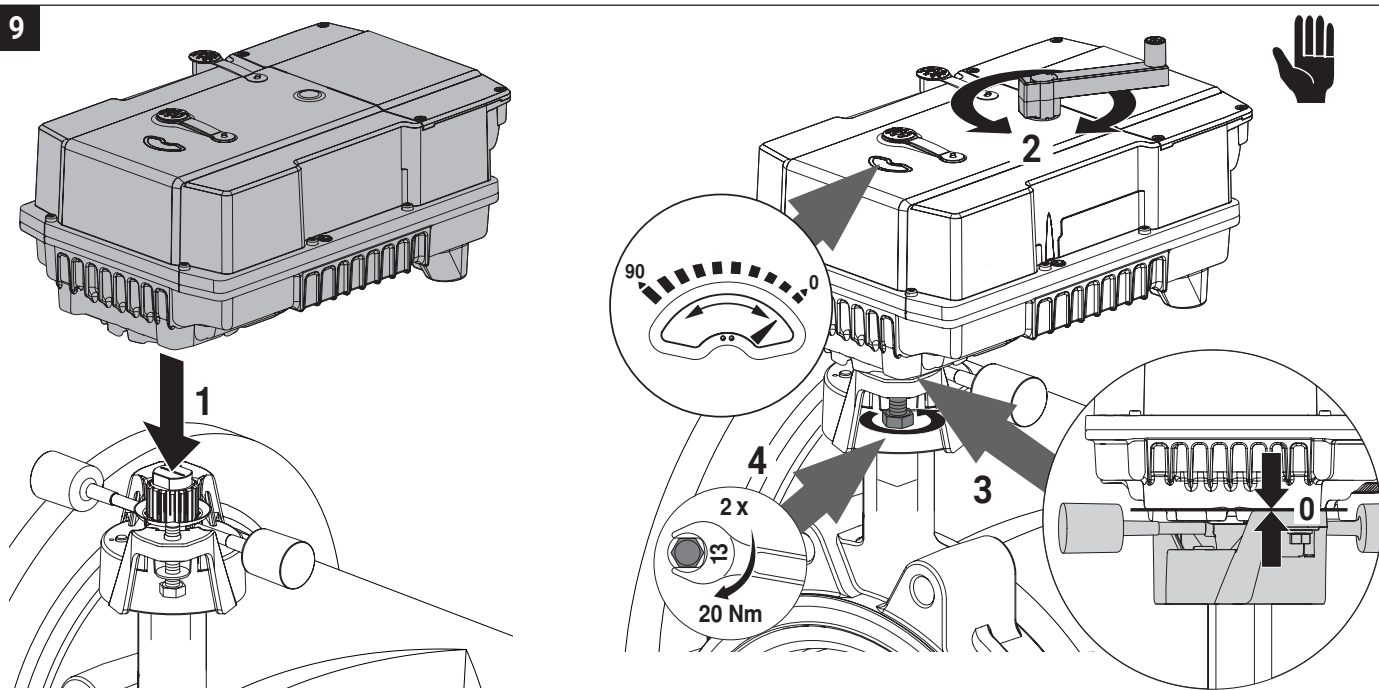

10

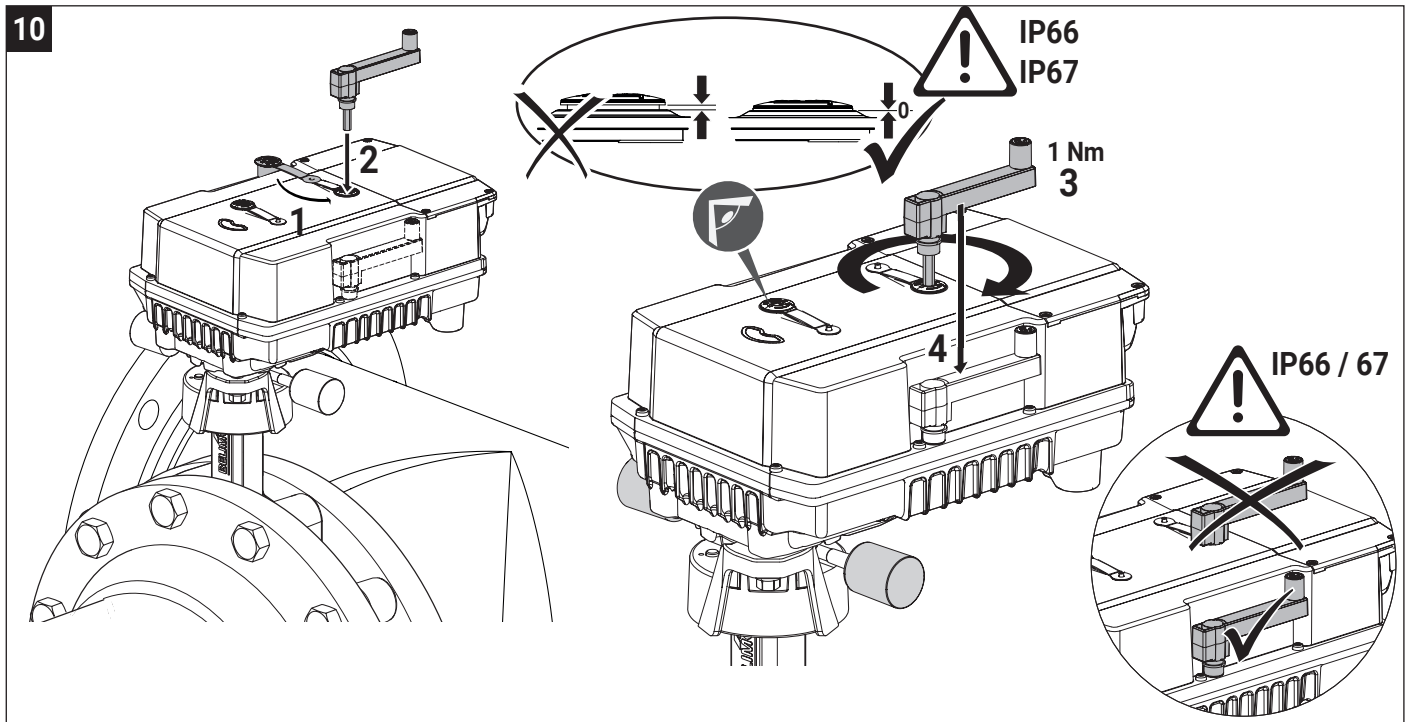

11

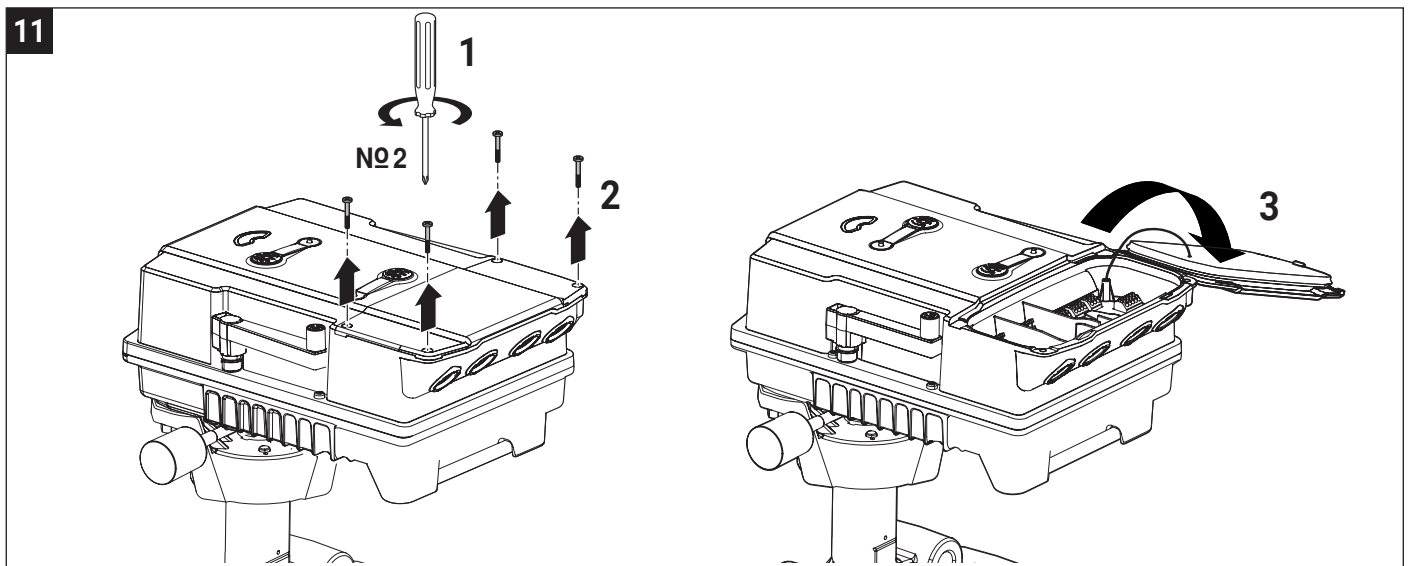

12

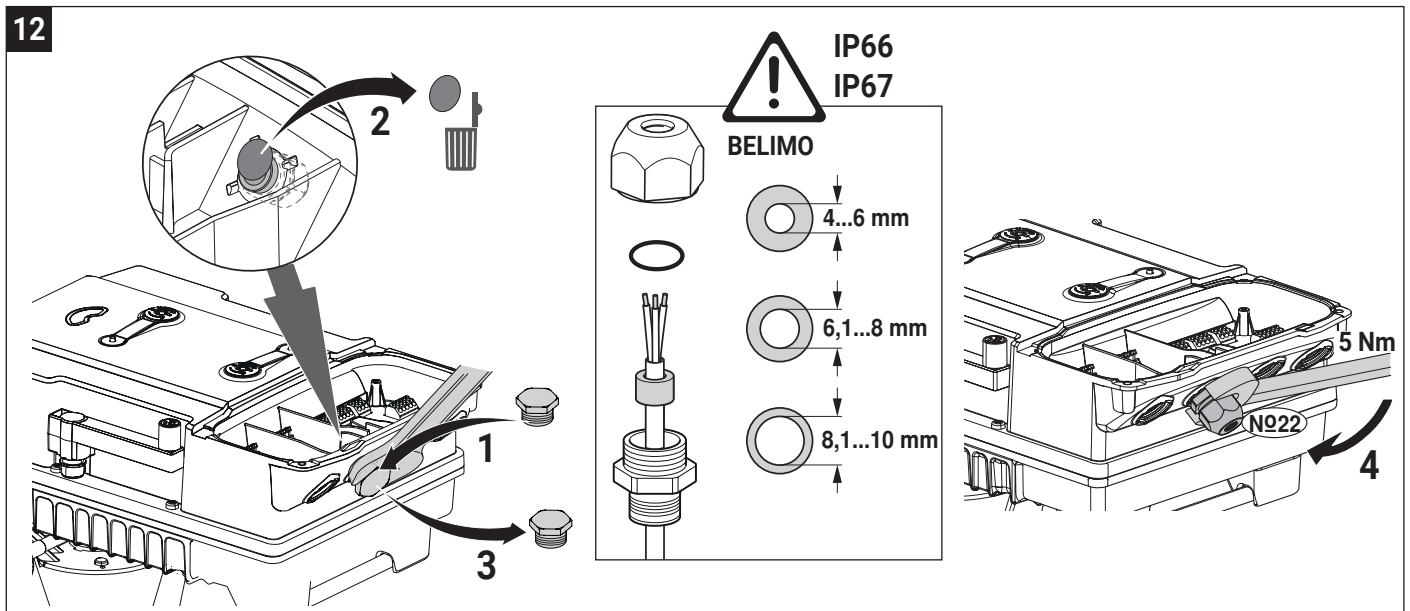

13

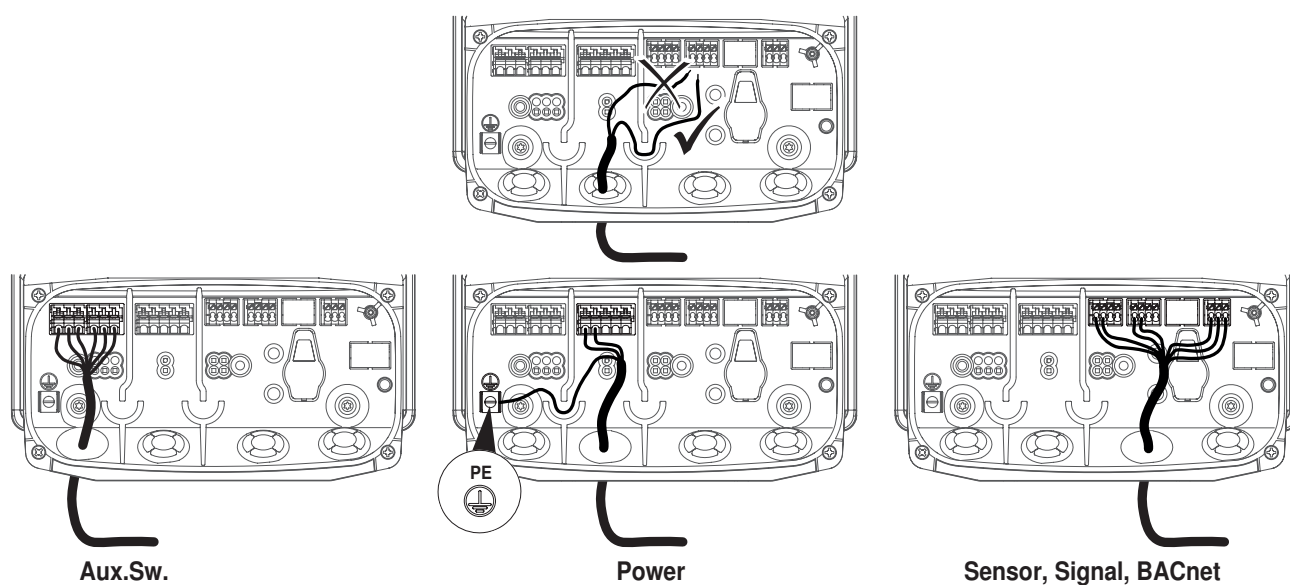
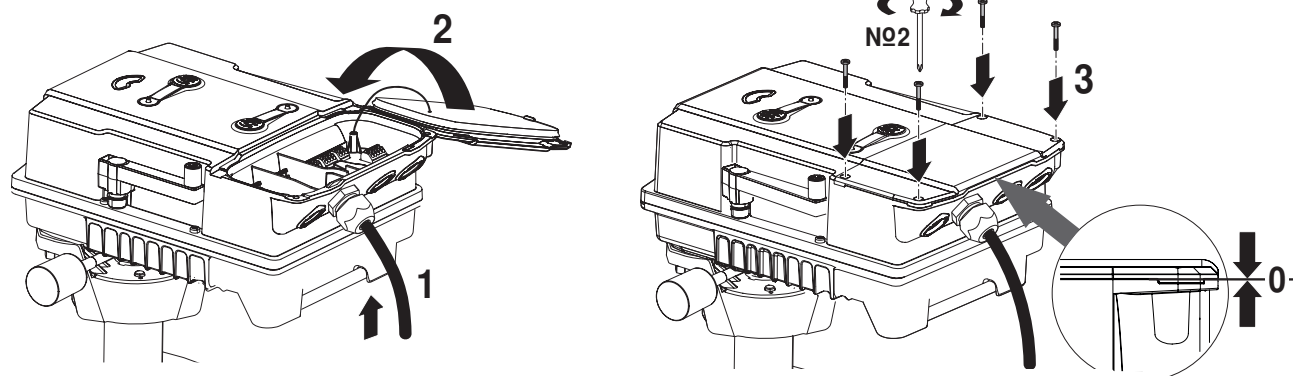

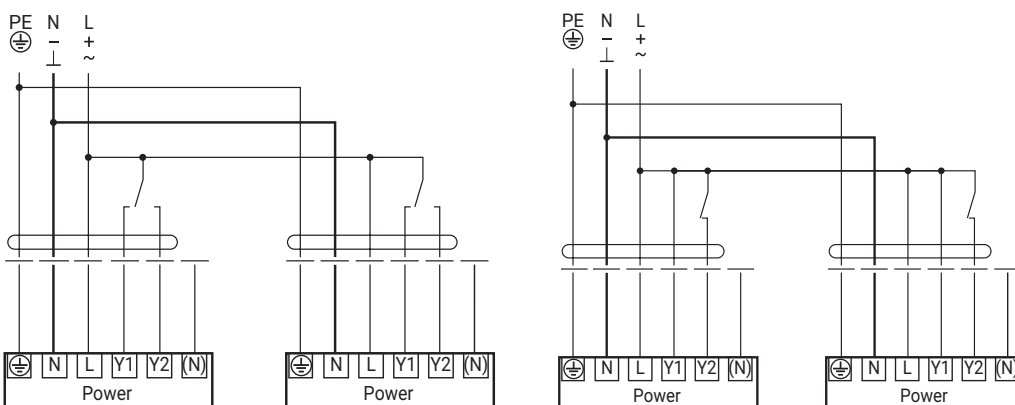
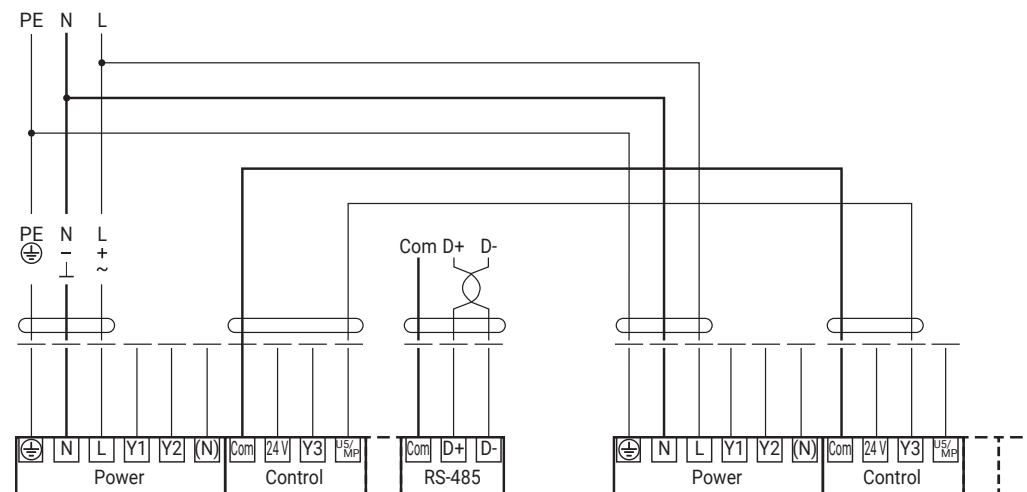
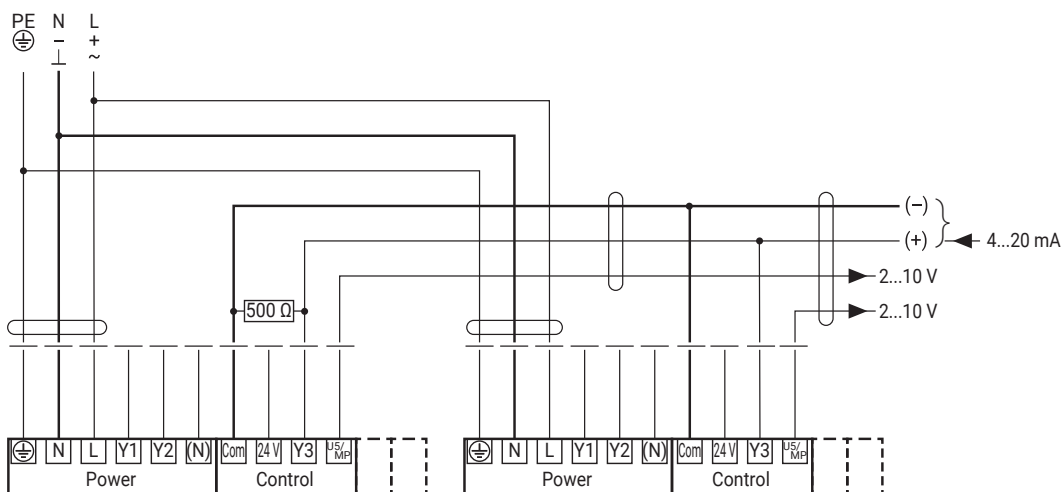
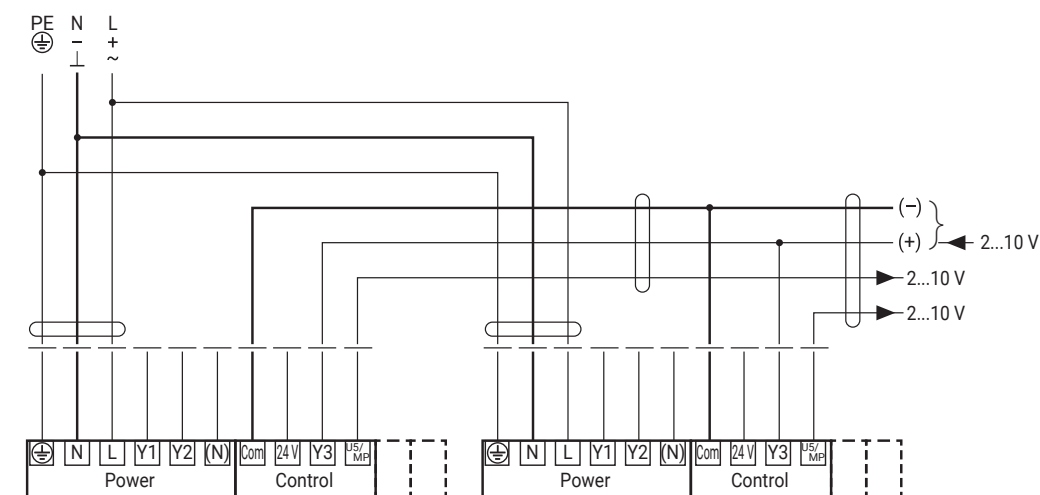
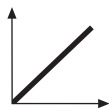

i

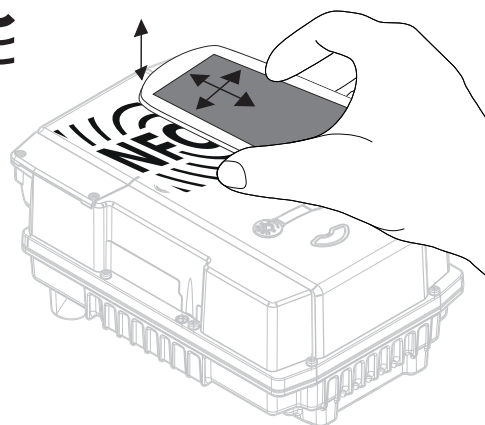
i

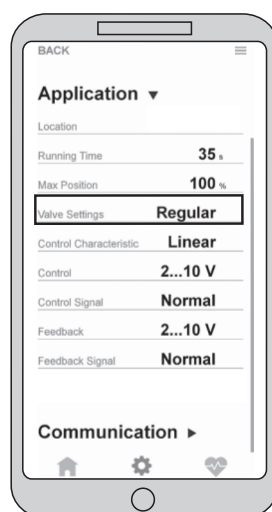
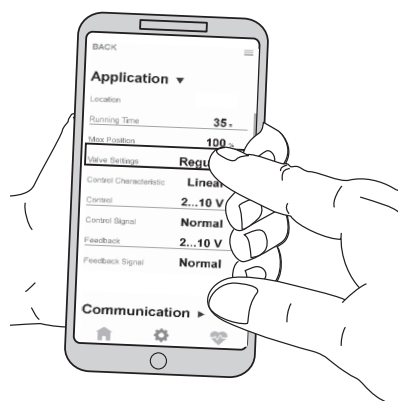

Regular	DN 80...150 D6300W(L) Retrofit
DN 200/8"	D6200W(L)
DN 250/10"	D6250W(L)



max. flow velocity
4 m/s

i

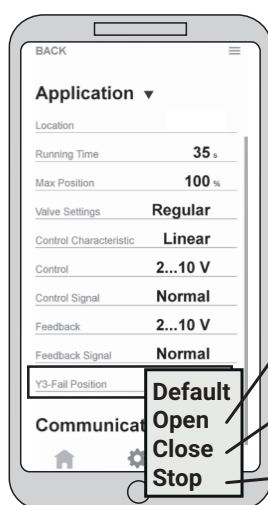
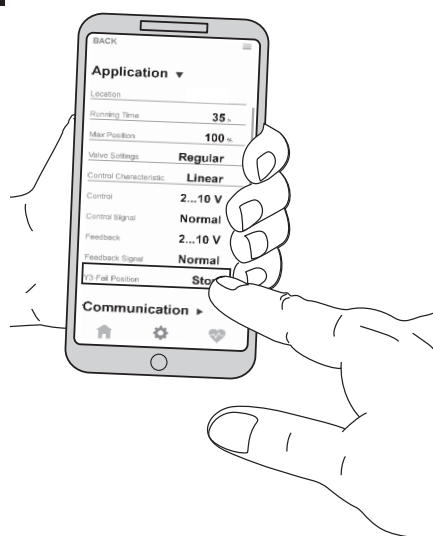

Y3-Fail
Position

Control Signal
Normal

Control Signal
Inverted

A-AB
Default



A-AB
100 %



A-AB
0 %



A-AB
STOP



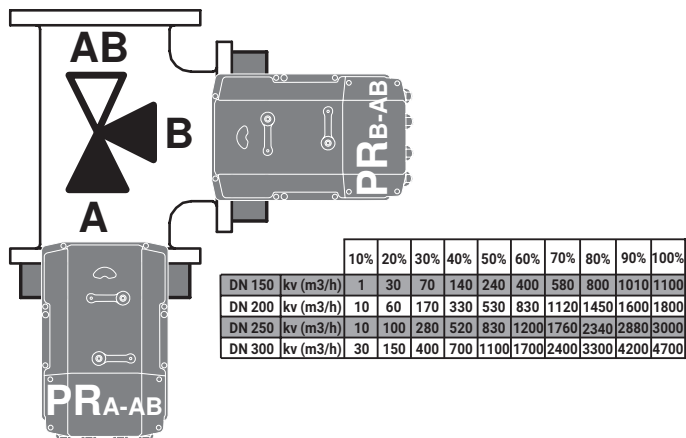

D7..L/BAC

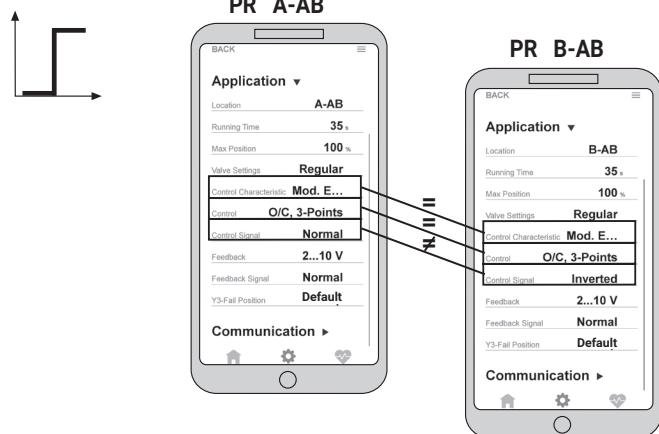

D7..L/BAC

